



LFX3 High Temperature LED Explosion-Proof Floodlight

Overview

The LFX3 is a high output, robust and reliable LED floodlight for use in oil & gas, petro-chemical, aviation, marine and utility applications.

Suitable for use in Zones 1,2,21 & 22, weatherproof to IP66 and with a robust LM6 alloy housing, the LFX3 is suitable for use in the harshest environments. The high temperature version has been designed and certified to work in the highest ambient conditions, up to +70°C.

Utilising high output LED light engines, the LFX3 provides excellent illumination while running very cool to ensure high reliability and long life.

Lumenox floodlights are fitted with our own custom built driver which ensures the driver lasts as long as the LED and is more suited to the extremes of temperature encountered in an explosion-proof application.

Heatsinking and thermal management has been optimised using CFD (computational fluid dynamics) to ensure maximum heat dissipation, essential for reliable LED functionality and long life.



Features

- ATEX/IECEX approved for use in Zones 1,2,21 and 22
- Certified for ambient temperatures up to 70°C
- Lightweight, robust and vibration resistant design
- High Light output, 3000 lm
- Instant Strike
- Robust, marine grade corrosion resistant alloy enclosure
- Universal 90V to 264V ac voltage range





Dimensions

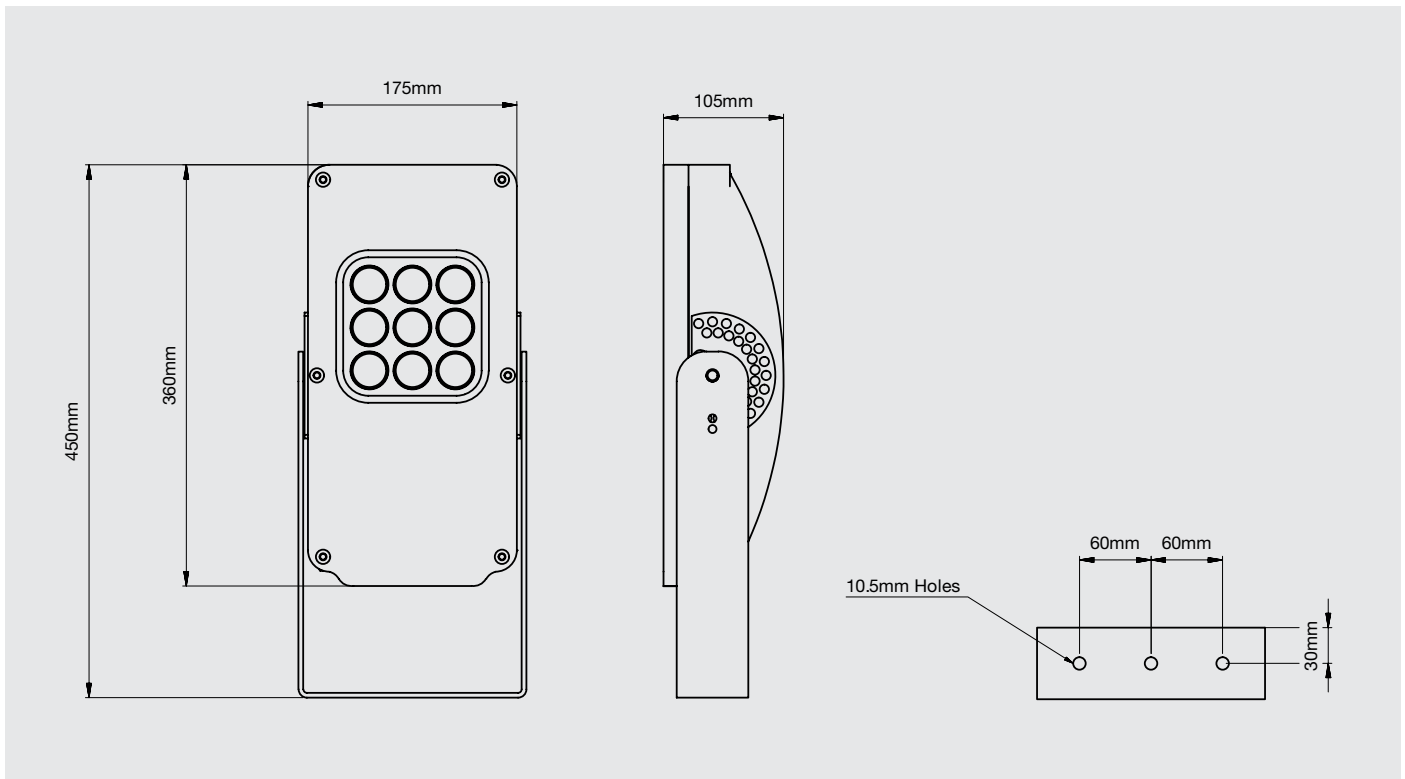

Technical Specification

Application	Oil & Gas, Petro-Chemical, Marine	
Certification	ATEX, IECEx II 2 G D Ex e mb IIC T6 Gb, Ex tb IIIC T85°C Db, Ta = -20°C to +40°C	ATEX, IECEx II 2 G D Ex e mb IIC T4 Gb, Ex tb IIIC T135°C Db, Ta = -20°C to +70°C
Ingress Protection	IP66	
Operating Temperature	-20°C to +70°C	
Weight	5.5 Kg	
Light Source	High Output LED	
Light Output	3,000 lm	
Colour Temperature	5700 K	
Colour Rendering Index (CRI)	>70	
Input Voltage	90V - 264V ac	
Current Consumption	200mA @ 230V ac	
Enclosure Material	LM6 Alloy	
Estimated Life	> 50,000 hours	

Part Number

Type	Beam Pattern	Cable Entries
LFX3-HT	(N) Narrow	(1) 2 x M20
	(M) Medium	(2) 2 x 1/2" NPT
	(W) Wide	

Example LFX3-HT-N-1

LUMENOX

Unit 19, The Mansley Centre, Timothy's Bridge Road, Stratford upon Avon, Warwickshire CV37 9NQ

+44 (0)1789 860000

sales@lumenox.co.uk

www.lumenox.co.uk