



Safety switch with separate actuator Extreme

ES 95 AZ 1Ö/1S IP66 Niro Extreme

Material number: 1190422 (Material number old: 95066901)

Features/Options:

- Version with higher degree of protection IP 66: From a distance of 2.5 to 3.0 m, the devices are treated with splashing water from different directions at 100 l per minute. The jet diameter is 12.5 mm, test duration is 1 min/m surface for at least 3 min.
- Salt-mist proof
- With NIRO screws and NIRO 1.4571 plunger

- Thermoplastic enclosure, double insulated \square
- Slow action \ominus , change-over contact with double break
- Wiring compartment
- Mounting details to EN 50047
- Horizontally slotted mounting holes

Notes

- 1 cable gland M20x1.5 - IP 66 included in delivery
- The actuator is not included in the delivery of the switches

Dimensions

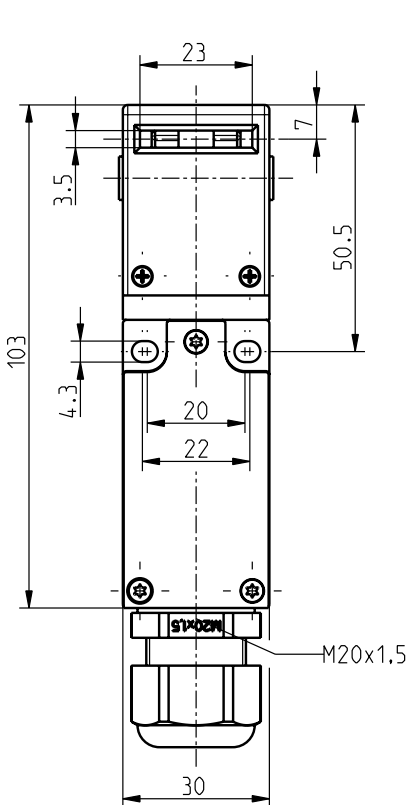

Technical data

Standards	EN ISO 13849-1; EN 60947-5-1; EN ISO 14119
Enclosure	glass-fibre reinforced, shock-proof thermoplastic (PA 66), self-extinguishing UL 94-V0
Tightening torque	mounting screw enclosure: max. 1.2 ... 1.3 Nm, cover screws: max. 0.7 Nm
Switch type	type 2
Degree of protection	IP 66 to IEC/EN 60529
Contact material	silver
Switching system	slow action, positive break NC contacts \ominus
Switching elements	1 NC/1 NO contact, type Zb
Connection	screw connection terminals
Cable cross-section	max. 1.5 mm ² (incl. conductor ferrules)
Cable entry	1 x M20 x 1.5
B _{10d} (10 % Load)	2 million
T _M	max. 20 years
U _{imp}	4 kV
U _i	400 V
I _{the}	6 A
I _e /U _e	6 A/400 VAC; 0.25 A/230 VDC
Utilisation category	AC-15; DC-13
Max. fuse rating	6 A gG/gN fuse

Errors and omissions excepted.



Safety switch with separate actuator Extreme

ES 95 AZ 1Ö/1S IP66 Niro Extreme

Material number: 1190422 (Material number old: 95066901)

Technical data

Positive break travel 9 mm

Ambient temperature -20 °C ... +80 °C

Mechanical life > 1 million operations

Approvals



Weight 106 g

Contact diagram

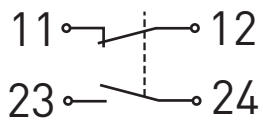

Switching diagram

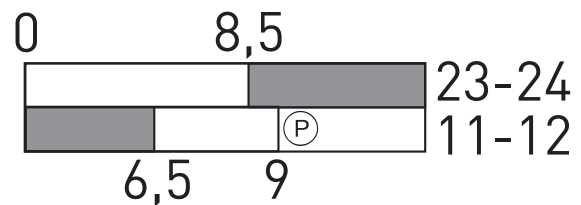

Note
Inserted position of actuator = 0 in switching diagram.
The actuator is not included with the switches.